

312 SERIES REGULATORS



The 312 Series dual stage regulators are intended for primary pressure control of non-corrosive, liquefied, or high purity (up to grade 5.5) gases. Two stages of pressure regulation minimize pressure variation arising from inlet pressure changes, such as the depletion of the supply cylinder, making the 312 Series regulator ideal for applications where constant delivery pressure is critical.

Typical Applications

- EPA Protocol Gases
- Gas and Liquid Chromatography
- High Purity Carrier Gases
- Zero, Span, and Calibration Gases
- High Purity Chamber Pressurization



3123331-01-580 shown

Features

- CAPSULE® Seat** increases serviceability and life
- Low Wetted Surface Area** minimizes purge requirements
- 316L Stainless Steel Diaphragm** prevents inboard diffusion
- Convolute Diaphragm** provides smooth pressure changes
- Compact Design** permits easy transport and system integration
- 10-Micron Filtration in Both Stages** offers fail-safe seat performance
- Field-Adjustable Pressure Limit** safeguards downstream equipment
- Pressure Ranges 0-15 to 0-250 PSIG (0-1 to 0-17 BAR)** facilitates a range of applications

Materials and Specifications

- Maximum Inlet Pressure (bare body):** 3000 PSIG (210 BAR); optional 3500 PSIG (240 BAR) or 4500 PSIG (310 BAR)
- Body:** Chrome-plated brass barstock
- Bonnet:** Chrome-plated, die-cast zinc
- Gauges:** 2 in (50 mm) diameter plated case
- Seats:** PCTFE (first stage); PTFE (second stage)
- Filter:** 10-micron sintered bronze
- Temperature Range:** -40°F to 140°F (-40°C to 60°C)
- Diaphragm:** 316L stainless steel
- Cv:** 0.1 See *flow curves attached*
- Helium Leak Integrity:** 1×10^{-8} scc/sec
- Internal Seals:** PTFE
- Ports (bare body):** 1/4 in FPT
- Weight (312 2331-580):** 4.4 lbs (1.98 kg)
- Conformances:** Cleanliness meets or exceeds CGA G-4.1; PED 2014/68/EU; ANSI/ASME B40.1; CRN OH5216

312 SERIES REGULATORS



Installation Dimensions

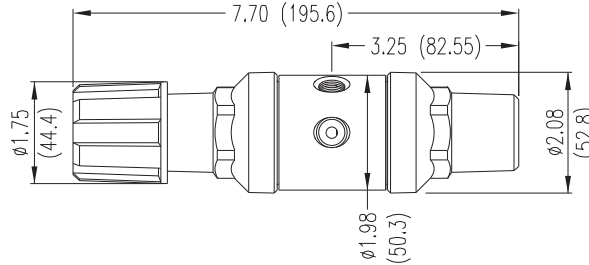
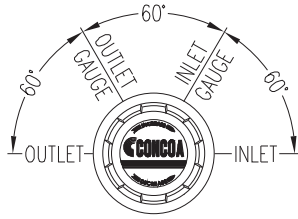

Ordering Information

312	A	B	C	D	-CON	Options	
Series 312	Outlet Pressure	Outlet Gauge	Inlet Gauge	Outlet Assemblies	Assembly Gauges	Inlet Connections	Installed Options
1: 0-15 PSIG (0-1 BAR)	30 in -0-30 PSIG/ -1-0-2 BAR	0: None	0: 1/4 in FPT port	0: Bare body	000: 1/4 in FPT	B: Protocol alarm station with pressure switch gauges	
2: 0-50 PSIG (0-3.5 BAR)	30 in -0-100 PSIG/ -1-0-7 BAR	3: 0-4000 PSIG/ 0-275 BAR	1: 1/4 in MPT	1: Standard assembly (PSIG/kPa gauges)	TF2: 1/8 in tube	C: Protocol switchover station	
3: 0-100 PSIG (0-7 BAR)	30 in -0-200 PSIG/ -1-0-14 BAR	5: 0-1000 PSIG/ 0-70 BAR	2: 1/4 in tube fitting	2: Standard assembly (BAR/PSIG gauges)	TF4: 1/4 in tube	E: Protocol alarm station with intrinsically safe transducer for hazardous environments	
4: 0-250 PSIG (0-17 BAR)	0-400 PSIG/ 0-27 BAR	6: 0-300 PSIG/ 0-21 BAR	3: Diaphragm valve 1/4 in tube fitting		TF6: 3/8 in tube	H: Protocol switchover alarm station with pressure switch gauges	
7: 0-150 PSIG (0-10 BAR)	30 in -0-200 PSIG/ -1-0-14 BAR	7: 0-400 PSIG/ 0-27 BAR	4: Diaphragm valve 1/4 in MPT		M06: 6 mm tube	J: Protocol alarm station with standard transducer for non-hazardous environments	
		8: 0-6000 PSIG/ 0-405 BAR*	5: Needle valve 1/4 in MPT		CGA DIN 477 BS 341 and others available	K: Protocol switchover alarm station with standard transducer for non-hazardous environments	
		G: 0-4000 PSIG/ 0-275 BAR†	6: 1/8 in tube fitting			M: Protocol station	
	<i>*Maximum inlet pressure 4500 PSIG (310 BAR) with PCTFE Seat CAPSULE®</i>		7: 3/8 in tube fitting			Q: Protocol purge station*	
	<i>*Maximum inlet pressure 3500 PSIG (240 BAR) with PCTFE Seat CAPSULE</i>		8: Diaphragm valve 1/8 in tube fitting			T: Tee purge*	
			9: Diaphragm valve 1/4 in FPT			X: Protocol switchover alarm station with intrinsically safe transducer for hazardous environments	
			A: 3/8 in BSP RH fitting			<i>*Not available with 4500 PSIG (310 BAR) max inlet pressure</i>	
			B: Diaphragm valve 3/8 in tube fitting				
			C: 3/8 in BSP LH fitting				
			D: 6 mm brass hose barb (not available if A=4 or 5)				
			G: 1/8 in stainless steel tube fitting				
			H: 1/4 in stainless steel tube fitting				
			M: 6 mm tube fitting				
			S: Diaphragm valve 6 mm tube fitting				

Flow Curves for 312, 315, 332, 411, 412, 414, 415, 430, 432 Series

